



DEFEND R™

The Industry's First Purpose-Built, All-Glass Ballistic Door



Comprehensive
Protection



Class A
Elegance



Effortless
Operation



Built
to Last



Simple to Install,
Adjust & Maintain

ballisticglassandarmor.com

The Defendoor™ Difference

Comprehensive Protection

A tested and proven ForceShield™ against ballistic attacks and forced entry

Class A Elegance

Sophisticated design showcases expanse of glass for unobstructed view

Effortless Operation

Proprietary hardware enables hefty door to be opened effortlessly with just two fingers

Simple to Install, Adjust & Maintain

Faster and easier to install than standard all-glass doors; cleans like regular glass

Built to Last

Rigorously tested to operate flawlessly for 1.8 million cycles

Standard hardware in Defendoor™ assemblies includes:

- 6-1/2" top and bottom rails with brushed stainless-steel cladding
- 60" brushed stainless steel ladder pulls
- Fully adjustable bottom pivot with a custom adjusting tool
- Heavy-duty, concealed overhead closer
- Magnetic locking system (other options available)

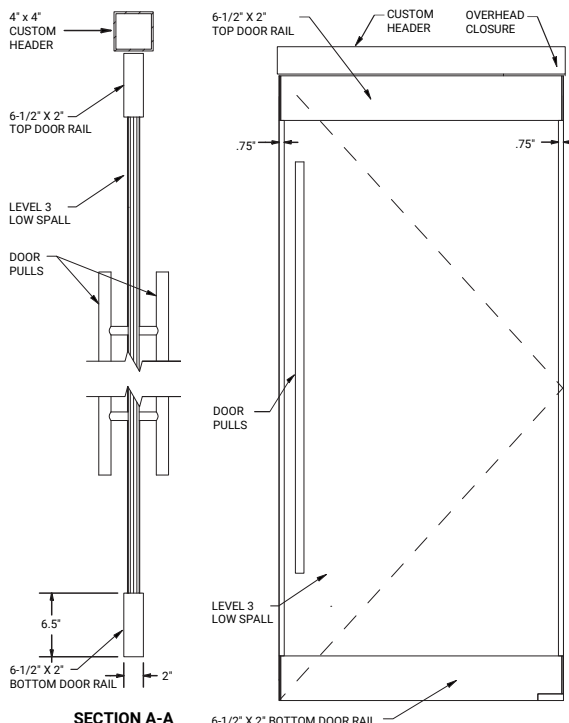
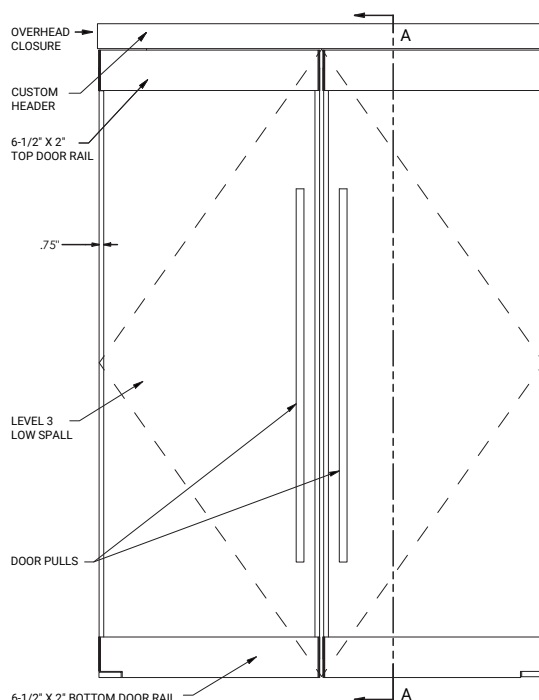

SIZING	Width: 36" or 42" (single); 72" (double) Height: Any height up to 108"
WEIGHT	36"x108" weighs ~400lbs
GLAZING	GCP 1-1/8" thickness Low-iron float glass option available
WARRANTY	5/3 years on interior/exterior glass; 2 years on hardware If glass is ever damaged in a shooting or forced entry crime, we'll replace it for free—for life*
FINISHES	Alternate cladding options available at additional cost

SECURITY	Magnetic locking system and floor dead bolt (alternate options available by request) Compatible with leading access control and power supply (not included)
ADD-ONS	Ballistic storefront framing, sidelites, and transom
STANDARDS	Level 3 low spall ballistic door Glazing tested to ASTM 3561 Standard Specification for Forced Entry Active Shooter Attack ASTM C 1172 Standard Specification for Laminated Architectural Flat Glass ASTM B 209/B 209M Standard Specification for Aluminum and Aluminum Alloy Sheet and Plate

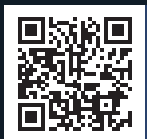

(972) 707-0105
sales@ballisticglassandarmor.com
ballisticglassandarmor.com

*Conditions apply. Learn more about our best-in-class ForeverSafe™ replacement program on ballisticglassandarmor.com.